

82

8/27

TEILAUFHEBUNG

Teilauflhebung
Bebauungsplan D3 der
Gemeinde Wiesmoor
Maßstab 1:1000

234

8/56

Illexstraße

Oidenburger Straße - L 12

Nordgeorgsfehnkanal

Mülberger Straße



Hls Satzung beizubehalten am
12. März 2001
Wiesmoor, 03. Juli 2006
J. Kluge

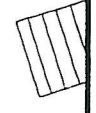
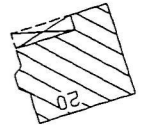
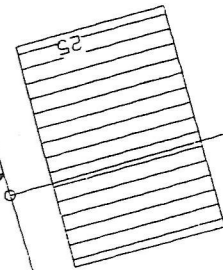
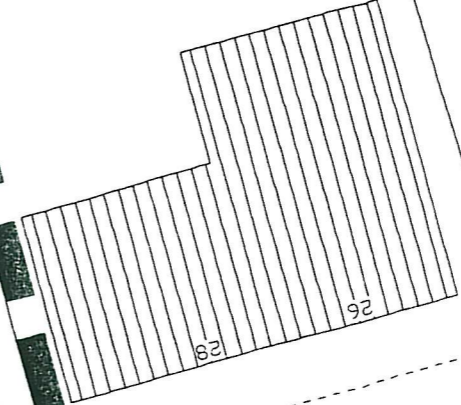
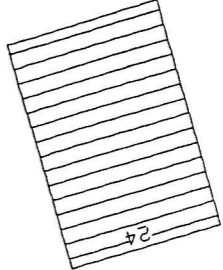

8/60

8/66

8/65

8/5

234